

AxiCool fans for unit coolers and evaporators

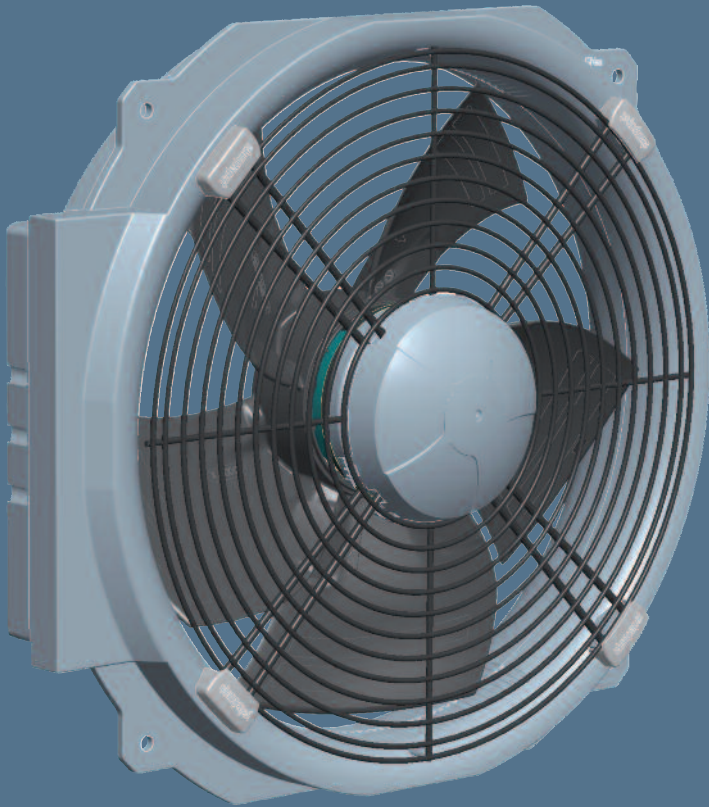

The engineer's choice

ebmpapst

AxiCool fans of the HyBlade® series

Starting in 2013, stringent efficiency guidelines in accordance with the ErP directive will also apply to fans that are used in cooling units and evaporators. This is no longer a hurdle with new AxiCool fans using GreenTech EC technology. Additionally, with the optional streamer, high throw distance can be attained while keeping the design compact. The integrated wall ring with guard grille is robust and easy to clean mechanically in the case of icing. The HyBlade® series is the basis for AxiCool fans - this provides all of the advantages in terms of noise and control.

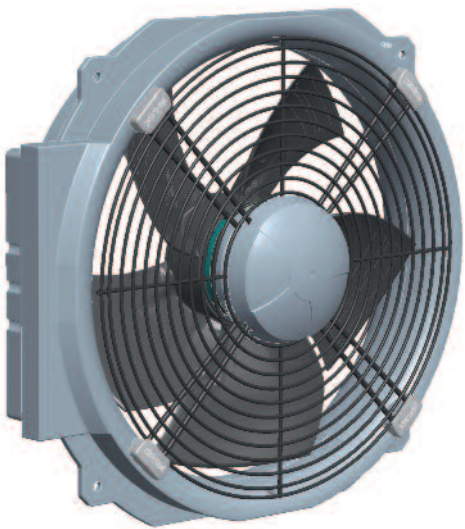

Standard version with guard grille



Streamer version

Benefits:

- Robust design: The flat metal guard grille is easy to clean mechanically in the case of icing
- Closed surfaces: Build up of dirt is minimised by the surface design with plain areas and without visible screws
- Direction of air flow "V" and "A" (with guard grille version)
- EC designs offer high efficiency (ErP limit is surpassed) and control options (2 speed steps or 0-10 V input)
- Aeroacoustic optimised design
- Two-part plastic wall ring with cavity chamber:
 - On the customer's side, a heating tape can be inserted
 - Reduces heat load
 - Reduces icing
- Simple installation ("Plug & Play")
- Compact design
- Increased motor protection against splash water

Additional benefits of streamer version:

- Almost doubled throw distance at comparable air flow
- Easy installation of the retrofittable streamer

Up to 25% lower energy consumption compared to conventional cooling units with AC fans.

Heating tape in the cavity wall ring

The customer can integrate a heating tape in the two-part cavity wall ring. The cavity chamber in the wall ring reduces the entry of heat into the cooling chamber. So the heat is generated where it is required which prevents ice formation between the axial blades and the wall ring. The heating tape can be inserted later because of the removable wall ring.

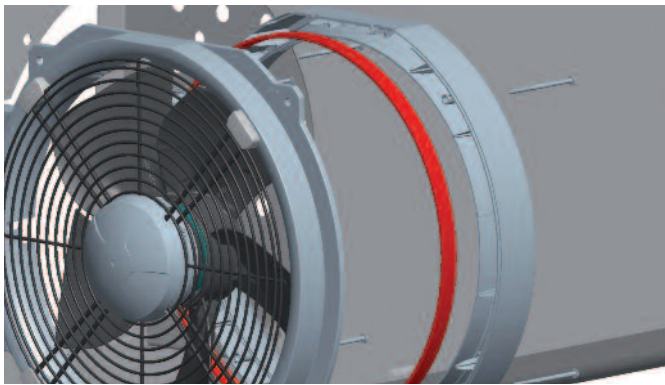

Mounting flange with swivel joint

The integrated mounting flange with swivel joint simplifies cleaning for the heat exchanger.

Just the 4 mounting screws have to be loosened to fold the fan easily to the side.

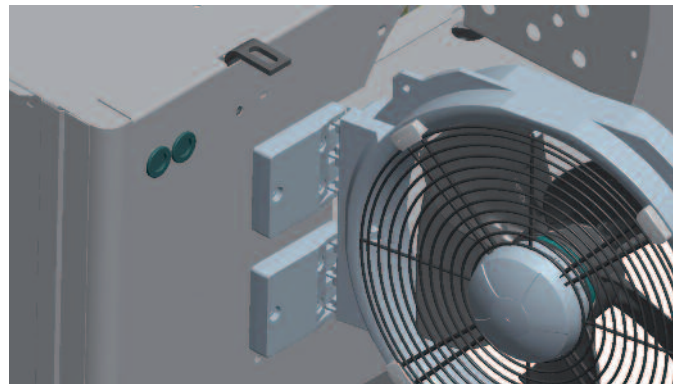

The AxiCool fan series, with and without swivel joint

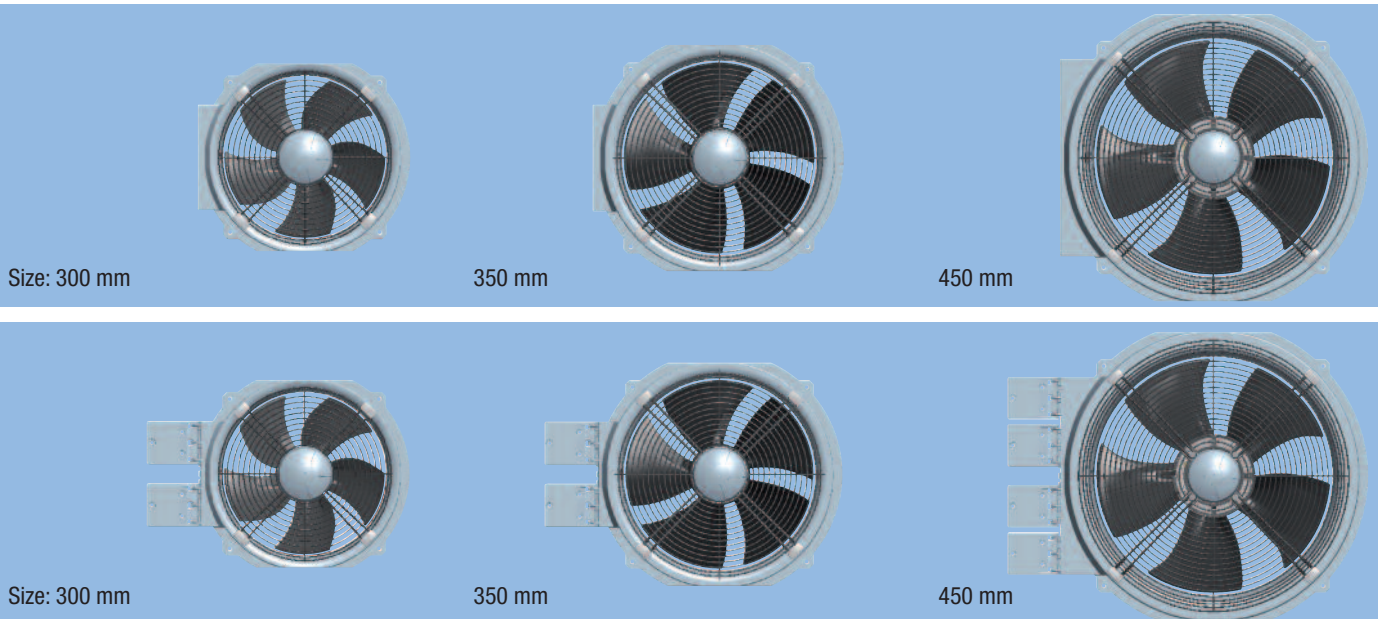

ebm-papst
Mulfingen GmbH & Co. KG

Bachmühle 2
74673 Mulfingen, Germany
Phone +49 7938 81-0
Fax +49 7938 81-110
info1@de.ebmpapst.com

www.ebmpapst.com